

mySafe

Code

350 / 450



High intensive alarm function

2 emergency keys included

back up power supply included



OPERATING MANUAL



facebook.com/BASIGmbH



[@basi_gmbh](https://www.instagram.com/basi_gmbh)



www.basi.eu

General notes

Intended use

The electronic furniture safe keeps important documents, papers, contracts, certificates and electronic data media safe. The electronic furniture safe can be used privately or in the office.

Follow the instructions in this manual on how to use the electronic furniture safe correctly.

Warnings: No hazards are to be expected, if the device is used correctly and in accordance with the instructions. Small parts and packaging materials can be swallowed by children and lead to choking! Make sure that small parts and packaging materials do not get into the hands of children. Dispose of the packaging material immediately.

The manufacturer expressly reserves the right to make technical changes.

Disclaimer

The manufacturer accepts no liability for damage or injury resulting from incorrect handling.

Cleaning/maintenance

Slight soiling of the electronic furniture safe can be removed with a damp cloth.



Disposal

Help to protect the environment and dispose of the product and the packaging materials in accordance with the local regulations.

The device may not be disposed of with the regular household trash, it must be collected separately.



Scope of delivery

Check that the delivery is complete:

- 1x electronic furniture safe
- 1x operating manual
- 2x keys

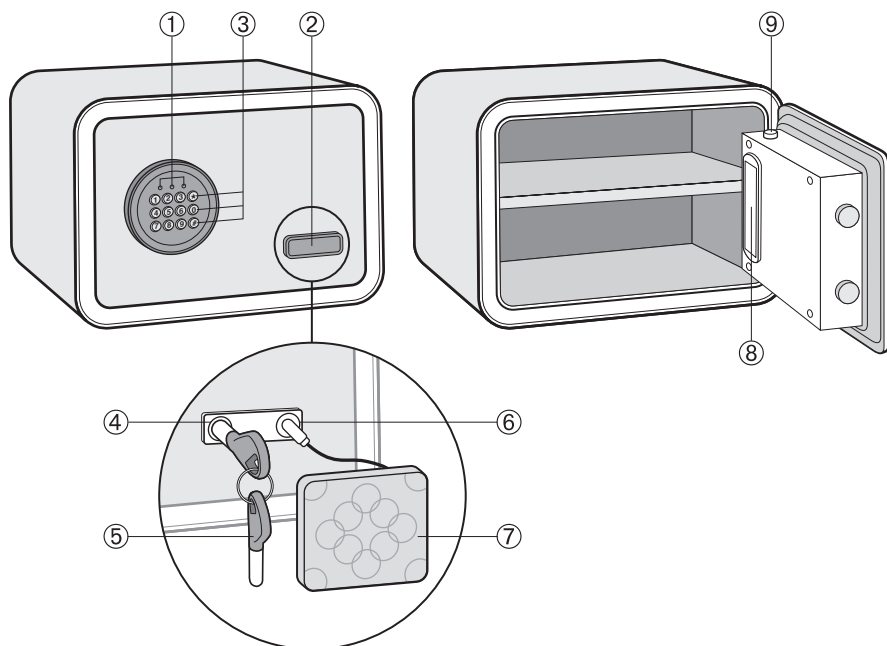

- 1 Light (yellow, green, red)
- 2 Plate
- 3 Keypad
- 4 Emergency keyhole
- 5 Emergency keys
- 6 Battery-power check inlet
- 7 Battery backup system
- 8 Built-in battery box
- 9 Reset button



1 First time operation

Open with the emergency key

1. Uncover the plate at the bottom of the safe to reveal the emergency keyhole and battery-powered jack inlet.
2. Insert the emergency key into the keyhole, and turn the key counterclockwise.
3. Do not release the key; otherwise the key will return to its original position.
4. Turn the handle clockwise to open the door.
5. Open the battery box cover on the back of the door.
6. Mount four AA batteries in the battery box.

Open with passcode

1. Uncover the plate at the bottom of the safe to reveal the emergency keyhole and battery-powered jack inlet. Insert the battery backup system into the power jack inlet.
2. The safe comes with a factory-set passcode of „12345678“
3. Enter this passcode and press the“#“ button to confirm.
4. The green light will turn on.
5. Turn the handle clockwise within six seconds to unlock the safe.
6. Open the battery box cover on the back of the door.
7. Mount four AA batteries in the battery box.

Change the passcode

1. Change the original passcode of „12345678“ to ensure safety.
2. Press the green reset button on the back of the door inside the safe. You will hear two short clicks and the yellow light will turn on.
3. Enter any pass code from 1 to 8 digits in length. You will hear two short clicks and the yellow light will turn off.

2 Opening & closing the safe

Opening

1. Enter your passcode. You will hear two short clicks and a green light will turn on.
Press the “#” button to confirm.
2. Turn the handle clockwise within six seconds to open the safe.

Closing

1. Close the door and turn the handle counterclockwise to close.

3 Alarm

Wrong code

- When wrong pass code is entered, the yellow light flashes six times.
- If you enter the wrong passcode 3 times in a row, the safe will sound the alarm for 40 seconds.
- During the alarm, and a correct pass code to cancel the alarm.

Vibration alarm mode

The vibration alarm mode has to be activated before in operation.

1. Press the“#“button.
2. You will hear two short clicks and the yellow light flashes six time to activate the alarm mode. The alarm is activated after 10 seconds. Once activated, the alarm it will sound for 40 seconds if this safe is shaken or moved.
3. To cancel the alarm, enter the correct pass code. Afterwards the alarm has to be activated again.
4. Note: the vibration alarm mode can be activated while the safe door is both locked and unlocked.

4 Battery

Low battery level

On entering the passcode, if the green and red light switch on at the same time, it indicates that the batteries are low.

Battery replacement

If the batteries are dead, open the safe with the battery backup system. Replace the batteries.

5 Forgotten passcode and Emergencies

In case you forgot your passcode or the electronic system breaks down:

1. Insert the emergency key into emergency keyhole.
2. Turn the emergency key counter clockwise and do not release the key; otherwise, the key will return to its original position.
3. Turn the handle clockwise to open the door.
4. In case of forgotten passcode, open the safe as instructed above and reset the passcode for future use.

6 Tips and warnings

- Do not store the user manual, emergency key or the external power supply box in the safe.
- If the safe is not in use for extended periods of time, remove the batteries to prevent damage to the safe's electronic liquid system.
- If mounting the safe onto a wall, ensure that the wall is structurally secure.

General notes

Intended use

The electronic furniture safe keeps important documents, papers, contracts, certificates and electronic data media safe. The electronic furniture safe can be used privately or in the office.

Follow the instructions in this manual on how to use the electronic furniture safe correctly.

Warnings: No hazards are to be expected, if the device is used correctly and in accordance with the instructions. Small parts and packaging materials can be swallowed by children and lead to choking! Make sure that small parts and packaging materials do not get into the hands of children. Dispose of the packaging material immediately.

The manufacturer expressly reserves the right to make technical changes.

Disclaimer

The manufacturer accepts no liability for damage or injury resulting from incorrect handling.

Cleaning/maintenance

Slight soiling of the electronic furniture safe can be removed with a damp cloth.

Disposal



Help to protect the environment and dispose of the product and the packaging materials in accordance with the local regulations.

The device may not be disposed of with the regular household trash, it must be collected separately.

Scope of delivery

Check that the delivery is complete:

- 1x electronic furniture safe
- 1x operating manual
- 2x keys

© Copyright

Reproduction or duplication (even excerpts thereof) is forbidden without approval of: BASI GmbH
Konstantinstraße 387
41238 Mönchengladbach, Germany

2025

This publication, including all its parts, is protected by copyright.

Any use outside the narrow limits of copyright law without the consent of BASI GmbH is not allowed and is liable to prosecution.

This applies in particular to duplications, translations, microfilming and importing and processing in electronic systems.

BASI GmbH, Konstantinstraße 387,
41238 Mönchengladbach, Germany